

Emaux V500 (Opus)
(500 л)



1.

1.1. _____.

Emaux V500 (Opus)

50 . . .

1.2. _____.

Emaux V500 (Opus)

1.

1

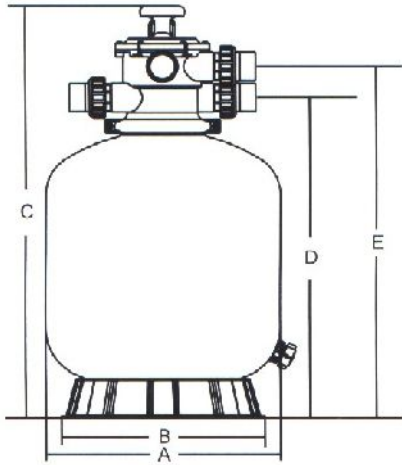

	A	B	C	D	E
	535	500	845	670	730

50

1.3. _____.

BHIMAHIE !!!

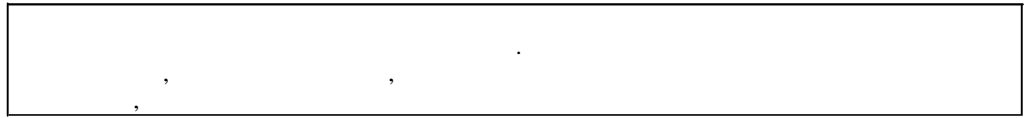

Emaux V500 (Opus)

4.2

15150.

Emaux V500 (Opus)

1

1

		100
		-
	°	+10 +35
	%	60
	°	40
		1,5
		50
		0,5-1,0
	2	0,22
40-50 /	. /	11,1
20-22 /	. /	5,5

1.4. _____.

Emaux V500 (Opus)

2, 3, 4;

2, 3, 4

2

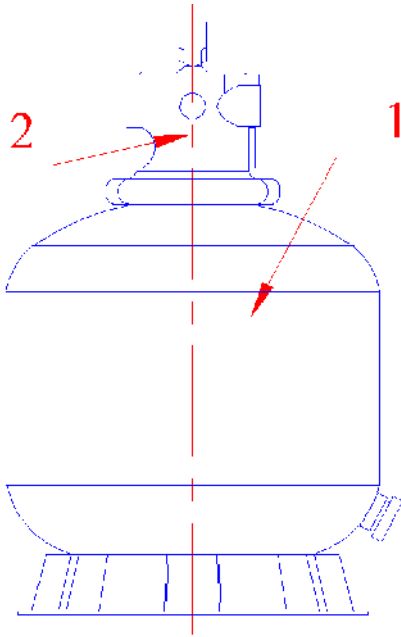

2

1	(500) (.) Emaux V500 (Opus)
2	6- .(1½") Emaux (Opus) MPV-01C

3 « 1 2» ((500) (.) Emaux V500 (Opus))

3

1	6- .(1½") Emaux (Opus) MPV-01C
2	Emaux (Opus) FT-03W-04-02, FT-03W-05
3	Emaux V500 (Opus) FT-01-003
4	Emaux V500 (Opus) MPV-01W-10-1, MPV-01W-10-2
5	(500) (.) Emaux V500 (Opus) FT-01-037
6	(500) (.) Emaux V500 (Opus) FT-01-031, FT-01-032, MPV-03W-03
7	(500) (.) Emaux V500 (Opus) FT-01-023
8	Emaux V500 (Opus) FT-01-007
9	() Emaux V500 (Opus) FT-01-010

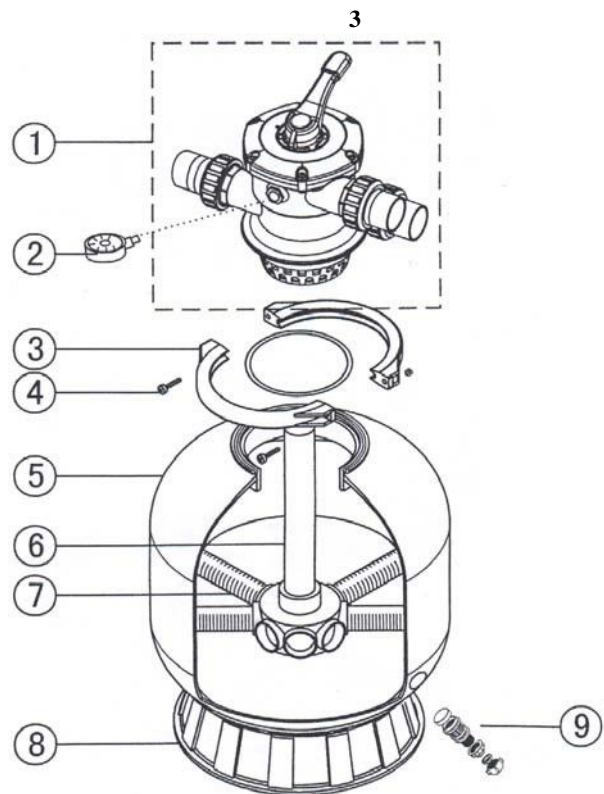

« 2 2» (6- .(1½") Emaux (Opus) MPV-01C)

4.

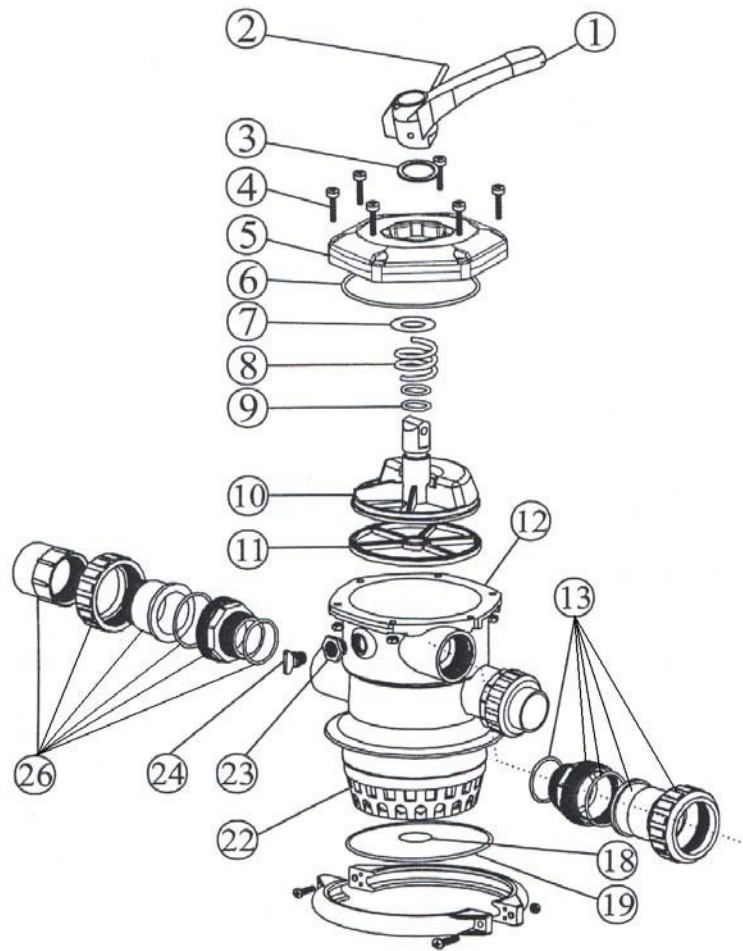

1	6-	Emaux (Opus) MPV-01-019
2	-	6- Emaux (Opus) MPV-01W-1
3		6- Emaux (Opus) MPV-01-006
4		6- Emaux (Opus) MPV-01W-02-1,
		MPV-01W-02-1
5	6-	Emaux (Opus) MPV-01C-004
6	-	6- Emaux (Opus) MPV-01W-03
7		6- Emaux (Opus) MPV-01-007
8	6-	Emaux (Opus) MPV-01W-04
9	-	6- Emaux (Opus) MPV-01W-05
10	6-	Emaux (Opus) MPV-01-005
11	()	6- Emaux (Opus) MPV-01-015
12	6-	Emaux (Opus) MPV-01-001
13	6-	1½" Emaux (Opus) (MPV-01W-06/MPV-03-004/MPV-01W-7/MPV-01-010/MPV-01-009)
18	-	6- () Emaux (Opus) MPV-01W-8
19	-	Emaux (Opus) MPV-01W-9B
22	6-	Emaux (Opus) MPV-01-012
23		6- Emaux (Opus) MPV-01-014
24	-	6- Emaux (Opus) CP-01W-05, CP-01-013
25		6- 1½" Emaux (Opus) (MPV-01-017/MPV-01-018)

1.5. _____:

Emaux V500 (Opus) :

- (500) () Emaux V500 (Opus);
- 6- .(1½”) Emaux (Opus) MPV-01C;

())

())

6- 1,5

6- .(1½”) Emaux (Opus) MPV-01C

- «1 (FILTER)» - ;
- «2 (BACKWASH)» - () ;
- «3 (RINSE)» - () ;
- «4 (WASTE)» - ;
- «5 (RECIRCULATE)» - ;
- «6 (CLOSED)» - 6- ;



5.

BHITMAHIE !!!

5

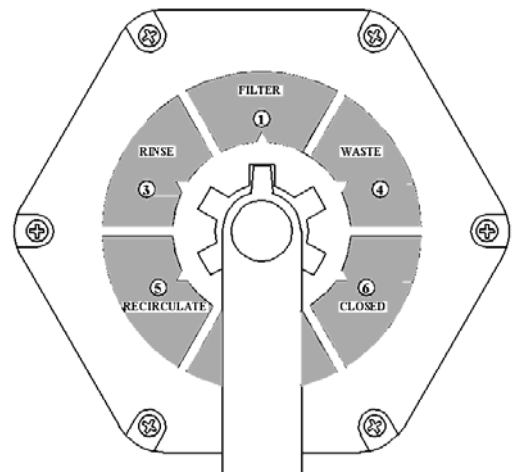

())
())

6.

BHITMAHIE !!!

BHITMAHIE !!!

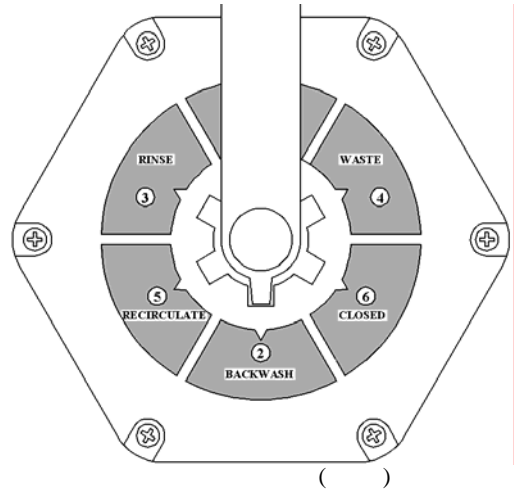

() () :

BHIMAHIE !!!

BHIMAHIE !!!

7

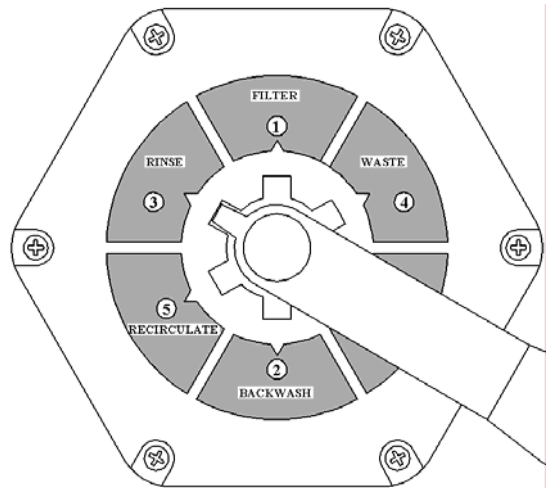

8.

BHIMAHIE !!!

8

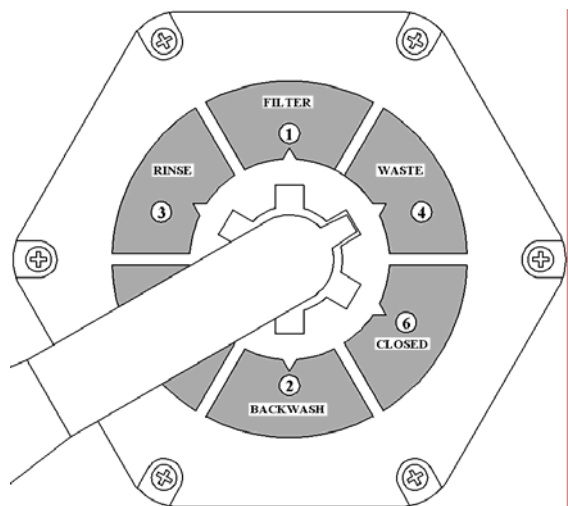

9.

BHITMAHIE !!!

9

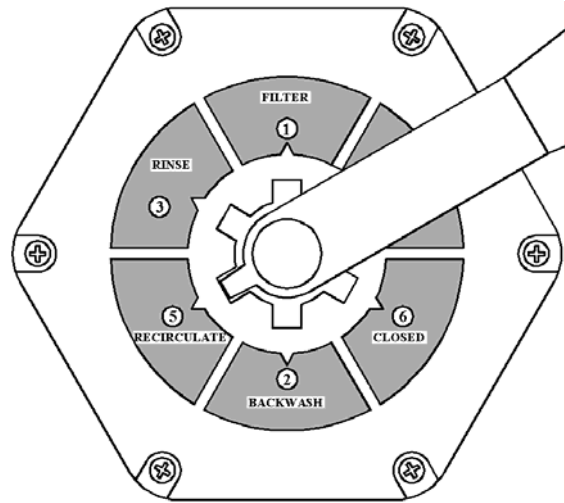

CLOSED 6-
CLOSED

10.

6-

BHITMAHIE !!!

10

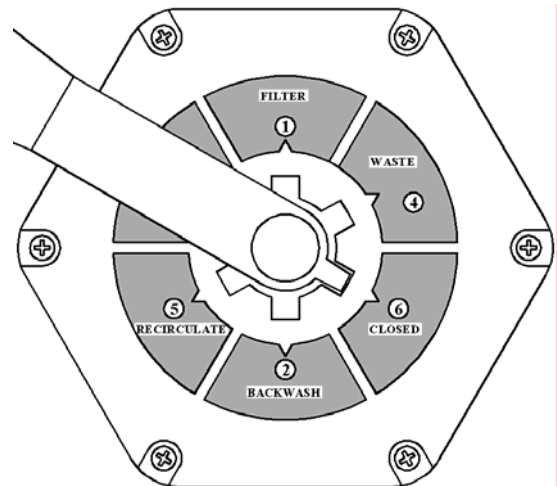

1.6. _____.

BHITMAHIE !!!

Emaux V500 (Opus)



(500) (. . .) Emaux V500 (Opus),

		870	550	550

2.

2.1. _____.

Emaux V500 (Opus)



<p>-</p> <p>- ;</p> <p>- ;</p> <p>- ;</p> <p>- ;</p>
--

2.2. _____.

Emaux V500 (Opus)

- 12.1.019-79 .
- 12.1.013-78 .
- 12.3.032-84 .
- 12.3.019-80 .
- 12.1.030-81 .
- 153-34.0-03.150-00. (. . .)
- 12.3.006-75 .
- 12.1.005-88 .
- 12.3.009-76 .
- 12-03-01. I.
- 12-04-02. 2.
- 12.1.004-91 .
- 01-93. .
- 22.0.01-94. .
- 22.3.03-94. .

2.3. _____.

Emaux V500

(Opus)

- . . . (. . .)
- . . .
- . . .
- 1%
- 60%,
- +10 +35 ° .
- . . .
- . . .
- . . .

Emaux V500 (Opus)

– Emaux V500 (Opus)

– Emaux V500 (Opus)

24-

– Emaux V500 (Opus)

2.4. _____

ВНИМАНИЕ !!!

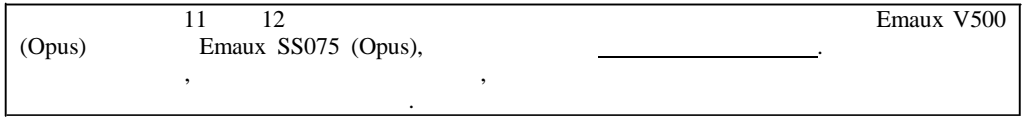

Emaux V500 (Opus)

ВНИМАНИЕ !!!

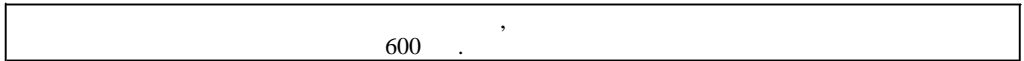

– Emaux V500 (Opus) (3) ()

2.1. 2.3.

1

Emaux V500 (Opus)

11.

11

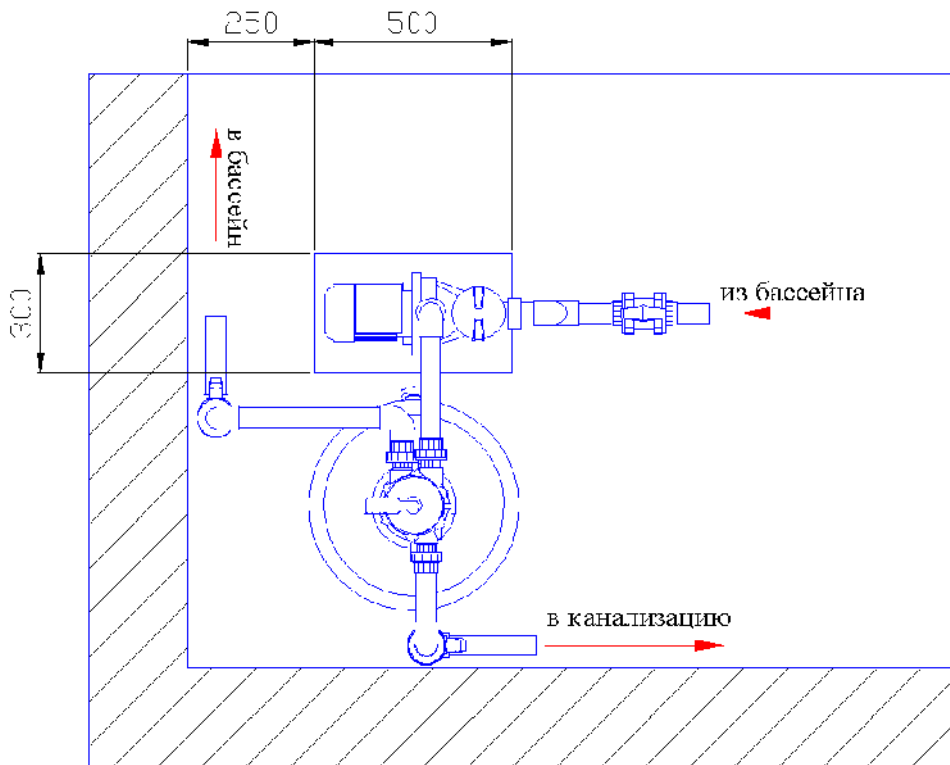

ВНИМАНИЕ !!!

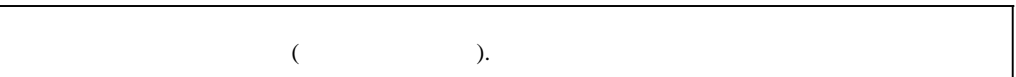

-
-
-
-
-

ВНИМАНИЕ !!!



- ()
-
-
- 6- (4 .19).
- 6- (3 3)



: () Emaux V500 (Opus) FT-01-003

- (3 .2) - (4 .24).



: 6-

- Emaux SS075 (Opus) « Emaux V500 (Opus) Emaux SS075 (Opus)».
- 5. 12.



:

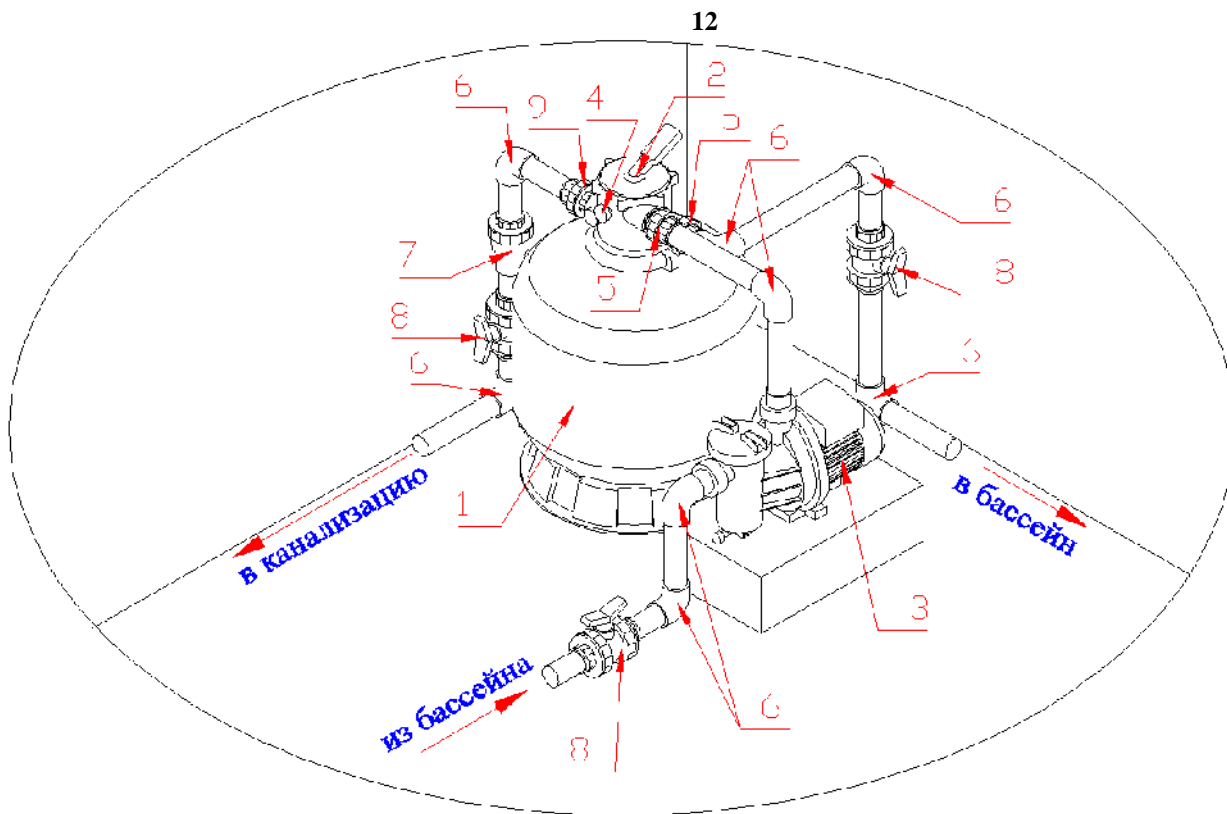

5

1	(500) () Emaux V500 (Opus)
2	6- .(1½") Emaux (Opus) MPV-01C
3	0,55 220 Emaux SS075 (Opus)
4	Emaux (Opus) FT-03W-04-02, FT-03W-05
5	6- 1½" Emaux (Opus) (MPV-01W-06/MPV-03-004/MPV-01W-7/MPV-01-010/MPV-01-009)
6	90 . . 50 Coraplast (7101050)
7	. 50 Coraplast (1310050)
8	. 50 Coraplast (1010050)
9	6- 1½" Emaux (Opus) (MPV-01-017/MPV-01-018)

— Emaux SS075 (Opus)
Emaux SS075 (Opus)».

«

ВНИМАНИЕ !!!

600

Emaux V500 (Opus)

:

6-

«6».

Emaux SS075 (Opus)

«

Emaux SS0

(Opus)».

;

13,

13



6- () Emaux V500 (Opus)

(500

) Ema V500 (Opus).

6-

2.5.

Emaux V500 (Opus)

:

()

()

Emaux SS075 (Opus)».

Emaux SS075 (Opus)

«



Emaux V500 (Opus),

2.6.

Emaux SS075 (Opus)

(1.5)

Emaux SS075 (Opus)»

()

()

Emaux SS075 (Opus)

(1.5)

Emaux SS075 (Opus)»



3.

3.1. _____

Emaux V500 (Opus)

BHUTMAHIE !!!

Emaux V500 (Opus)
.2.5 2.6



		Emaux V500 (Opus)	
-	:	Emaux V500 (Opus)	
-	.1.2.	Emaux V500 (Opus)	
-		4.2	15150
-			.1.2.
-		Emaux V500 (Opus)	
-	.51232-98	2.1.4.559-96	
-		6	
-	12	(
-);		4
-	;	Emaux V500 (Opus)	
-			
-			
-		Emaux V500 (Opus)	(
-);		
-			
-		Emaux V500 (Opus)	
-	;		
-			
-		Emaux V500 (Opus)	(
-	());
-		Emaux V500 (Opus)	
-		();
-	;		
-		()
-		Emaux V500 (Opus)	
-		6-	
-	6-		
-		Emaux V500 (Opus)	
-	“	”	
-		Emaux V500 (Opus)	
-		PH.	
-		Emaux V500 (Opus)	
-			

3.2. _____

Emaux V500 (Opus)
+5°C
Emaux V500 (Opus)
60%.
Emaux V500 (Opus)

24-

Emaux V500 (Opus) .2

3.3. _____.

Emaux V500
Emaux V500

(Opus) , ,
(Opus), . ,
Emaux SS075 (Opus). Emaux V500 (Opus)

6

Emaux V500 (Opus)

6

	.1.2.	
	(,)	(:)
		3
	.1.2.	
	/	
6-	6-	6-
6-	(1 1/2")	6-
	(,)	
	()	2

	()	
()		
	«) » (,	
		2
()		()
	(,	PH
	().	
		2
		2
	6- (1 1/2")	6-

3.4. _____.

12.3.019-80, « Emaux V500 (Opus) », « 2.2. ».
Emaux SS075 (Opus).



!	Emaux V500 (Opus)
---	-------------------

3.5. _____.

4.

4.1. _____.

Emaux V500 (Opus)

Emaux V500 (Opus) :

- ;
- ;
- ;
- ;
- ;
- ;
- ;
- 6- ;
- 6- ;
- () ;



Emaux V500 (Opus)

4.2. _____ . 2.2. . 3.4.

4.3. _____



! _____ Emaux V500 (Opus)

. 2.4.

4.4. _____

(_____ Emaux V500 (Opus) . 2.5.

4.4. _____

. 1.2. ()

:

. 2.4.

-
-
-

1.2. . 6.

5.

5.1. _____

ВНИМАНИЕ !!!

5.2. _____

. 2.2. . 3.4.

6.

Emaux V500 (Opus)

+10° +35°

60%



7.

Emaux V500 (Opus)

8.

Emaux V500 (Opus)

Emaux V500 (Opus)

9.

Emaux V500 (Opus)

« _____ » _____ 20 _____

10.

« _____ » _____ 20 _____

1.

(_____)

2.

12 (_____)

3.

:

4.

30 (_____)

90 (_____)

5.

(_____)

6.

7.

8.

8.1.

8.2.

8.3.

9.

9.1.

.8

9.2.

(_____)

10.

.8

.9

11.

12.

13.

14.

15.

16.

17.

18.

19.

14 ()

90 ()

()
