

Emaux V400 (Opus)
(400 л)



1.

1.1. _____.

Emaux V400 (Opus)

30 . . .

1.2. _____.

Emaux V400 (Opus)

1.

1

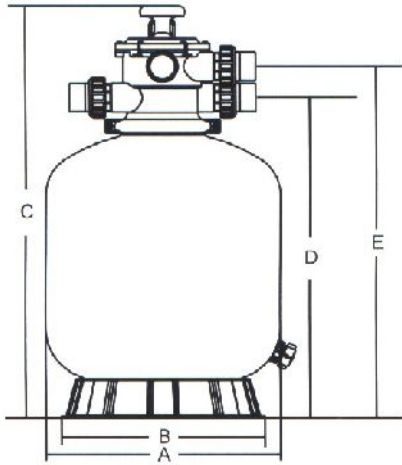

	A	B	C	D	E
	410	390	757	590	640

50

1.3. _____.

ВНИМАНИЕ !!!

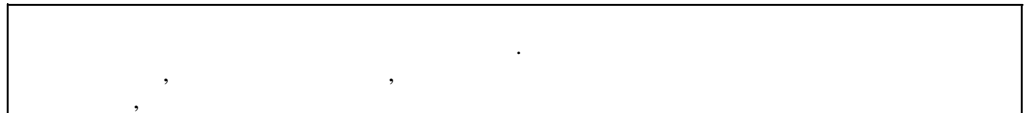

Emaux V400 (Opus)

4.2

15150.

Emaux V400 (Opus)

1

1

		45
		-
	°	+10 +35
	%	60
	°	40
		1,5
		50
		0,5-1,0
	2	0,13
40-50 /	. /	6,48
20-22 /	. /	3,24

1.4. _____.

Emaux V400 (Opus)

2, 3, 4;

2, 3, 4

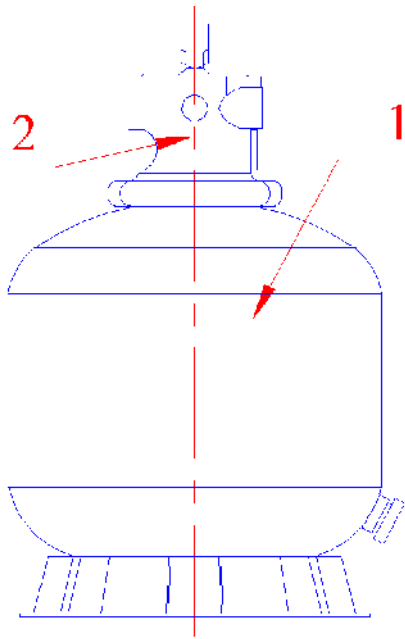

2

1	(400) (. . .) Emaux V400 (Opus)
2	6- .(1½") Emaux (Opus) MPV-01C

3 « 1 2» ((400) (. . .) Emaux V400 (Opus))

3

1	6- .(1½") Emaux (Opus) MPV-01C
2	Emaux (Opus) FT-03W-04-02, FT-03W-05
3	Emaux V400 (Opus) FT-01-003
4	Emaux V400 (Opus) MPV-01W-10-1, MPV-01W-10-2
5	(400) (. . .) Emaux V400 (Opus) FT-01-035
6	(400) (. . .) Emaux V400 (Opus) FT-01-031, FT-01-032, MPV-03W-03
7	(400) (. . .) Emaux V400 (Opus) FT-01-022
8	Emaux V400 (Opus) FT-01-008
9	(. . .) Emaux V400 (Opus) FT-01-010

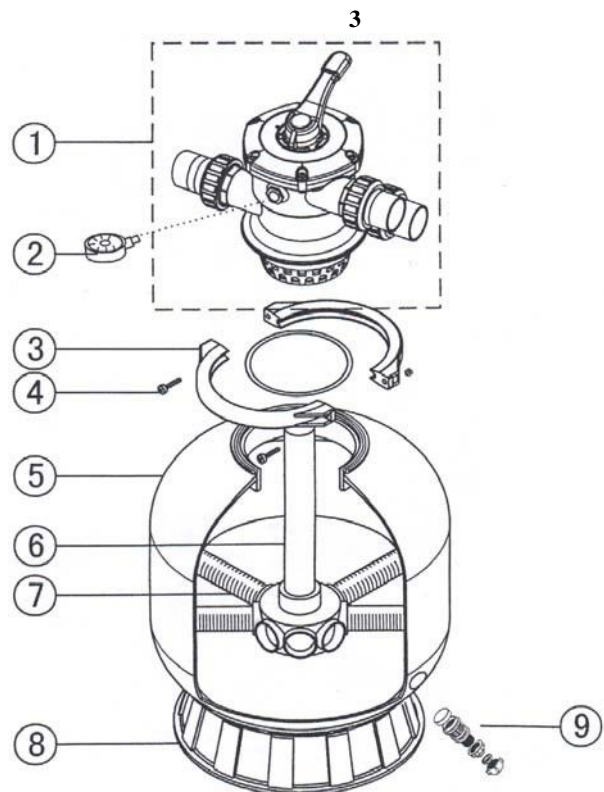

« 2 2» (6- .(1½") Emaux (Opus) MPV-01C)

4.

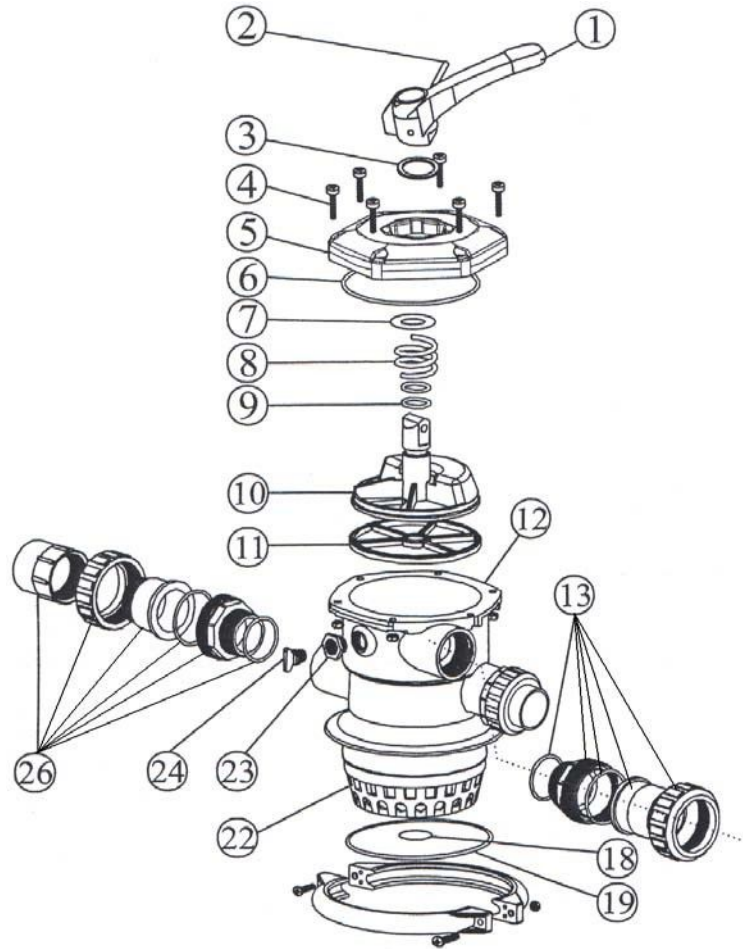

1	6-	Emaux (Opus) MPV-01-019
2	-	6- Emaux (Opus) MPV-01W-1
3		6- Emaux (Opus) MPV-01-006
4		6- Emaux (Opus) MPV-01W-02-1, MPV-01W-02-1
5	6-	Emaux (Opus) MPV-01C-004
6	-	6- Emaux (Opus) MPV-01W-03
7		6- Emaux (Opus) MPV-01-007
8	6-	Emaux (Opus) MPV-01W-04
9	-	6- Emaux (Opus) MPV-01W-05
10		6- Emaux (Opus) MPV-01-005
11		() 6- Emaux (Opus) MPV-01-015
12	6-	Emaux (Opus) MPV-01-001
13	6-	1½" Emaux (Opus) (MPV-01W-06/MPV-03-004/MPV-01W-7/MPV-01-010/MPV-01-009)
18	-	6- () Emaux (Opus) MPV-01W-8
19	-	Emaux (Opus) MPV-01W-9B
22	6-	Emaux (Opus) MPV-01-012
23		6- Emaux (Opus) MPV-01-014
24	-	6- Emaux (Opus) CP-01W-05, CP-01-013
2 6		6- 1½" Emaux (Opus) (MPV-01-017/MPV-01-018)

1.5. _____.

Emaux V400 (Opus) :

- (400) () Emaux V400 (Opus);
- 6- .(1½”) Emaux (Opus) MPV-01C;

())

())

6- 1,5

6- .(1½”) Emaux (Opus) MPV-01C

- «1 (FILTER)» - ;
- «2 (BACKWASH)» - () ;
- «3 (RINSE)» - () ;
- «4 (WASTE)» - ;
- «5 (RECIRCULATE)» - ;
- «6 (CLOSED)» - 6- ;



5.

BHITMAHIE !!!

5

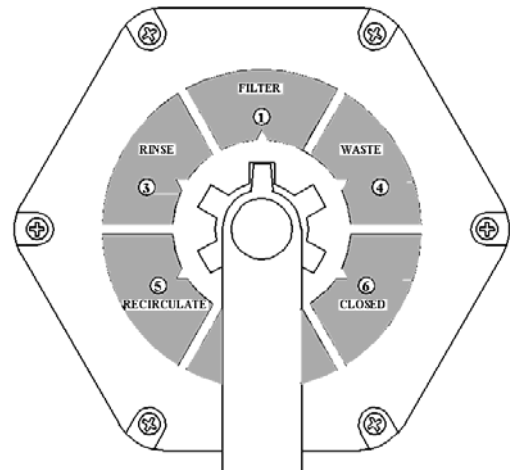

())

6.

BHITMAHIE !!!

BHITMAHIE !!!

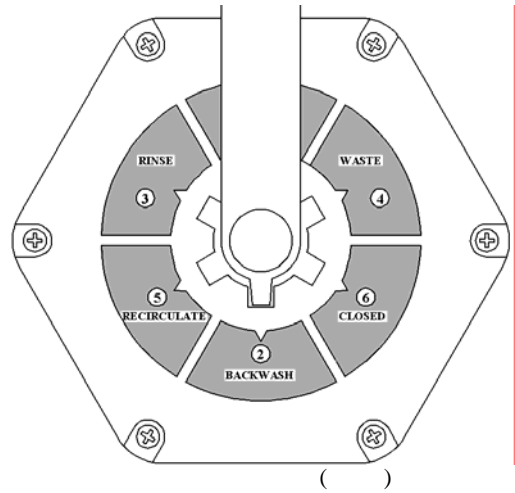

() () :

7.

BHIMAHIE !!!

BHIMAHIE !!!

7

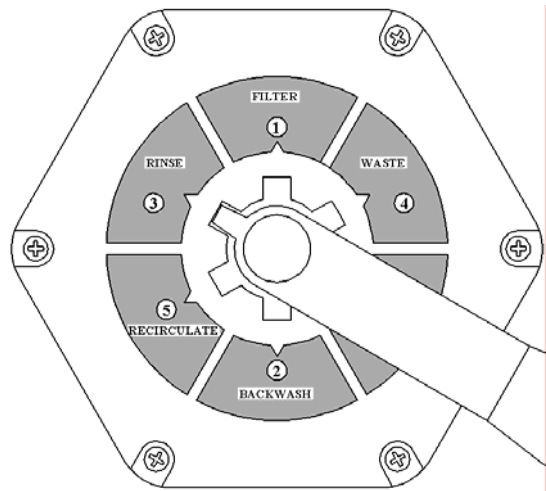

8.

BHIMAHIE !!!

8

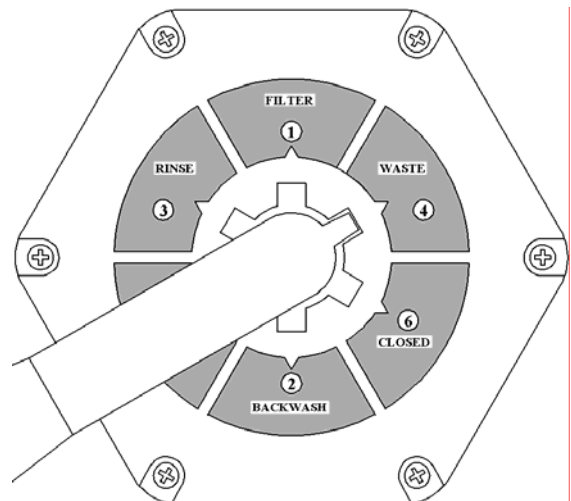

9.

BHITMAHIE !!!

9

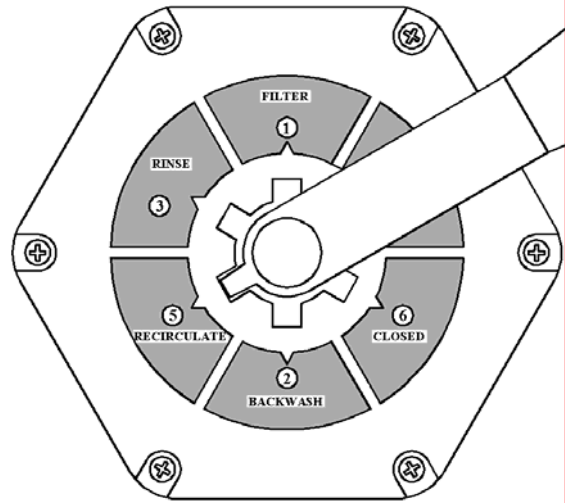

CLOSED 6-
CLOSED

10.

6-

BHITMAHIE !!!

10

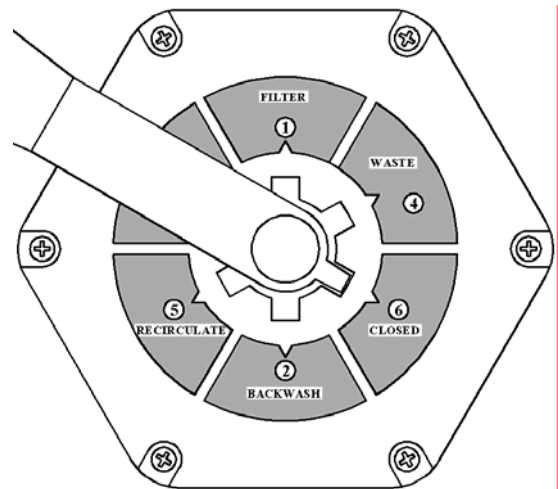

1.6. _____.

ВНИМАНИЕ !!!

Emaux V400 (Opus)



(400) (. . .) Emaux V400 (Opus),

		790	440	440

2.

2.1. _____.

Emaux V400 (Opus)



-	:		
-	;		
-	,		
-	:		

2.2. _____.

Emaux V400 (Opus)

- 12.1.019-79 .
- 12.1.013-78 .
- 12.3.032-84 .
- 12.3.019-80 .
- 12.1.030-81 .
- 153-34.0-03.150-00. (. . .)
- 12.3.006-75 .
- 12.1.005-88 .
- 12.3.009-76 .
- 12-03-01. I.
- 12-04-02. 2.
- 12.1.004-91 .
- 01-93. .
- 22.0.01-94. .
- 22.3.03-94. .

2.3. _____.

Emaux V400

(Opus)

- (. . .)

-

- 1%

- 60%,

- +10 +35 ° .

-

Емаux V400 (Opus)

Емаux V400 (Opus)

Емаux V400 (Opus)

24-

Емаux V400 (Opus)

2.4.

ВНИМАНИЕ !!!

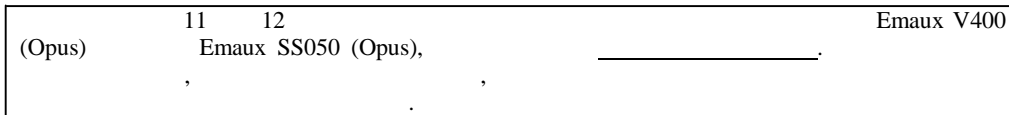

Емаux V400 (Opus)

ВНИМАНИЕ !!!

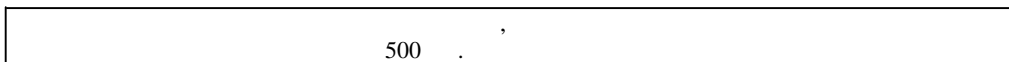

Емаux V400 (Opus)

(3)

2.1. 2.3.

1

Емаux V400 (Opus)

11.

11

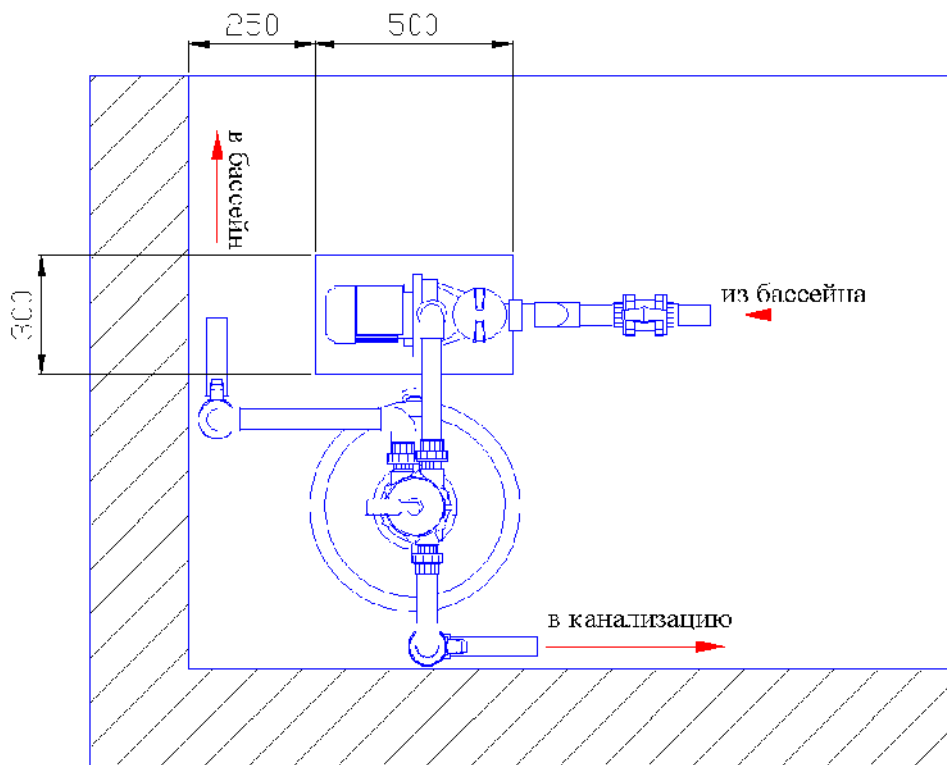

ВНИМАНИЕ !!!

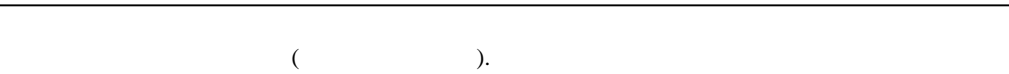

ВНИМАНИЕ !!!



- ()
-
- 6- (4 .19).
- 6- (3 .3)



: () Emaux V400 (Opus) FT-01-003

- (3 .2) - (4 .24).



: 6-

- Emaux SS050 (Opus) « Emaux SS050 (Opus)».
- Emaux V400 (Opus) 12.
- 5.



:

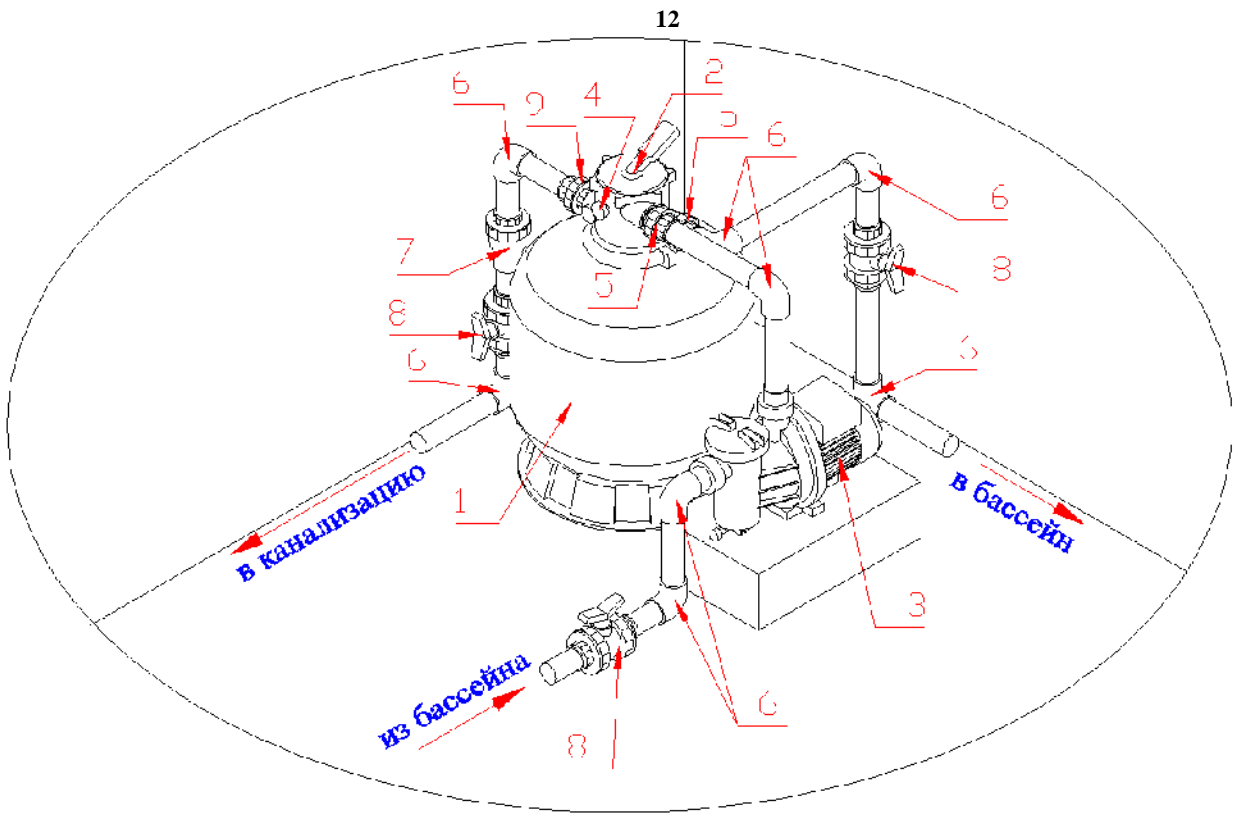

5

1	(400) (.) Emaux V400 (Opus)
2	6- .(1½") Emaux (Opus) MPV-01C
3	0,37 220 Emaux SS050 (Opus)
4	Emaux (Opus) FT-03W-04-02, FT-03W-05
5	6- 1½" Emaux (Opus) (MPV-01W-06/MPV-03-004/MPV-01W-7/MPV-01-010/MPV-01-009)
6	90 . . 50 Coraplast (7101050)
7	. 50 Coraplast (1310050)
8	. 50 Coraplast (1010050)
9	6- 1½" Emaux (Opus) (MPV-01-017/MPV-01-018)

— Emaux SS050 (Opus)
Emaux SS050 (Opus)».

«

ВНИМАНИЕ !!!

500

Emaux V400 (Opus)

:

6-

«6».

Emaux SS050 (Opus)

«

Emaux SS0

(Opus)».

;

13,

13



6- () Emaux V400 (Opus)

(400

) Ema V400 (Opus).

6-

2.5.

Emaux V400 (Opus)

:

()

()

Emaux SS050 (Opus)».

Emaux SS050 (Opus)

«



Emaux V400 (Opus),

2.6.

Emaux SS050 (Opus) (1.5)

Emaux SS050 (Opus)»

()

()

Emaux SS050 (Opus) (1.5)

Emaux SS050 (Opus)»



3.

3.1. _____

Emaux V400 (Opus)

BHITMAHIE !!!

Emaux V400 (Opus)
. 2.5 2.6



		Emaux V400 (Opus)	
:	Emaux V400 (Opus)		
-.1.2.	Emaux V400 (Opus)		
-.4.2	Emaux V400 (Opus)	15150	.1.2.
-.51232-98	Emaux V400 (Opus)	2.1.4.559-96	
-.12	(6	
-.);			4
-.;	Emaux V400 (Opus)		
-.;			
-.;	Emaux V400 (Opus)		(
-.);			
-.;	Emaux V400 (Opus)		
-.;			
-.;	Emaux V400 (Opus)	();
-. ()		;
-. Emaux V400 (Opus)		();
-.;			
-.;	()	
-. Emaux V400 (Opus)			
-.;		6-	
-. 6-	Emaux V400 (Opus)		
-. “	”		
-. Emaux V400 (Opus)			
-. PH.			
-. Emaux V400 (Opus)			

3.2. _____

+5°C Emaux V400 (Opus) 60%.

Emaux V400 (Opus)

Emaux V400 (Opus)

24-

Emaux V400 (Opus) .2

3.3. _____

(Opus)
(Opus),

Emaux V400
Emaux V400

Emaux V400 (Opus)
Emaux SS050 (Opus).

6

Emaux V400 (Opus)

6

	.1.2.	
	(,	(:
)	.). ,
		3
	.1.2.	
	(,	
)	
	/	
6-	6-	6-
6-	(1 1/2")	6-
	(,	
)	
	(2
)	

	()	
()		
	«) » (,	
		2
()		()
	(,	PH
)	
	().	
		2
		2
	6- (1 1/2")	6-

3.4. _____.

12.3.019-80, « Emaux V400 (Opus) », « 2.2. ».
Emaux SS050 (Opus).



! Emaux V400 (Opus)

3.5. _____.

4.

4.1. _____.

Emaux V400 (Opus)

Emaux V400 (Opus)

- ;
- ;
- ;
- ;
- ;
- ;
- ;
- 6- ;
- 6- ;
- () ;
-



: Emaux V400 (Opus)

4.2. _____
()

. 2.2. . 3.4.

4.3. _____



! Emaux V400 (Opus)

. 2.4.

4.4. _____

Emaux V400 (Opus)

. 2.5.

()

4.4. _____

. 1.2. ()

- . 2.4. ;

- ;

- 1.2. . 6. .

5.

5.1. _____

BHIMAHIE !!!

5.2. _____

. 2.2. . 3.4.

6.

Emaux V400 (Opus)

+10° +35°

60%



7.

Emaux V400 (Opus)

8.

Emaux V400 (Opus)

Emaux V400 (Opus)

9.

Emaux V400 (Opus)

« _____ » _____ 20 _____

10.

« _____ » _____ 20 _____

1.

()

2.

12 ()

3.

4.

30 ()

90 ()

5.

()

6.

7.

8.

8.1.

8.2.

8.3.

9.

9.1.

.8

9.2.

()

10.

.8

.9

11.

12.

13.

14.

15.

16.

17.

18.

19.

, , , , . : , , , , .

, , , , , , .

- , , , , , , , , , , , .

), .

, , , , , , , , , , , .

, , , , , , , , , , , .

14 () 90 ()

, , , , , , , , , , , .

, , , , , , , , , , , .

()

